

Hope you all had a Merry Christmas and wishing you a Happy New Year

27/12/2011

0 Comments

Grantham Coates Surveys Ltd.

Land - Engineering - Building Surveyors



Grantham Coates Surveys wishes all our clients and supporters a Very Merry Christmas and Happy New Year

0 Comments

High school laser scan

14/12/2011

0 Comments

Last week we carried out a 3d laser scan of a high school. On this occasion we used a Leica C10 laser scanner. The C10 performed well, even in high winds and occasional rain showers. The scan is primarily for elevations, but should also prove useful in providing building footprints for the full measured floor plans required.



0 Comments

River Survey Example uploaded and more Laser Scanning

6/12/2011

0 Comments

River & Rail Example uploaded

Please click on the image to download Example River and Rail survey drawing.



School Laser Scan

Later this week we will be laser scanning a large school on the south coast. Primarily for elevation drawings, but also to generate footprints and sectional information to aid internal measured building survey works.

0 Comments

Grantham Coates Surveys

Land - Engineering - Measured Building Surveyors



Archives

March 2016
November 2015
October 2015
April 2015
March 2015
January 2015
September 2014
August 2014
June 2014
March 2014
December 2013
October 2013
August 2013
May 2013
March 2013
February 2013
December 2012
November 2012
October 2012
September 2012
July 2012
June 2012
May 2012
April 2012
March 2012
February 2012
January 2012
December 2011
November 2011
October 2011
September 2011
August 2011

Categories

All
Building Surveys
Laser Scanning
Measured Building Surveys
News
Topographic Survey
Topographic Surveys

[View my profile on LinkedIn](#)

[RSS Feed](#)

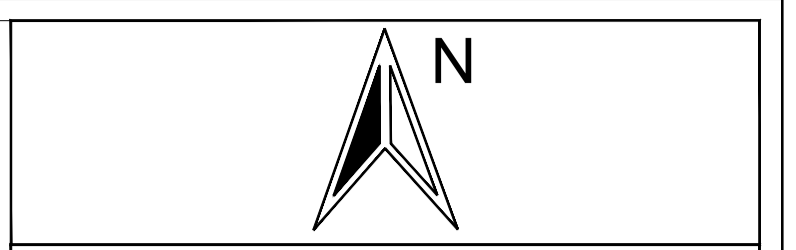
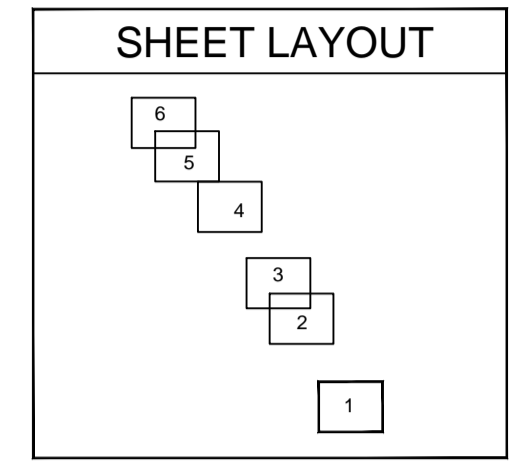
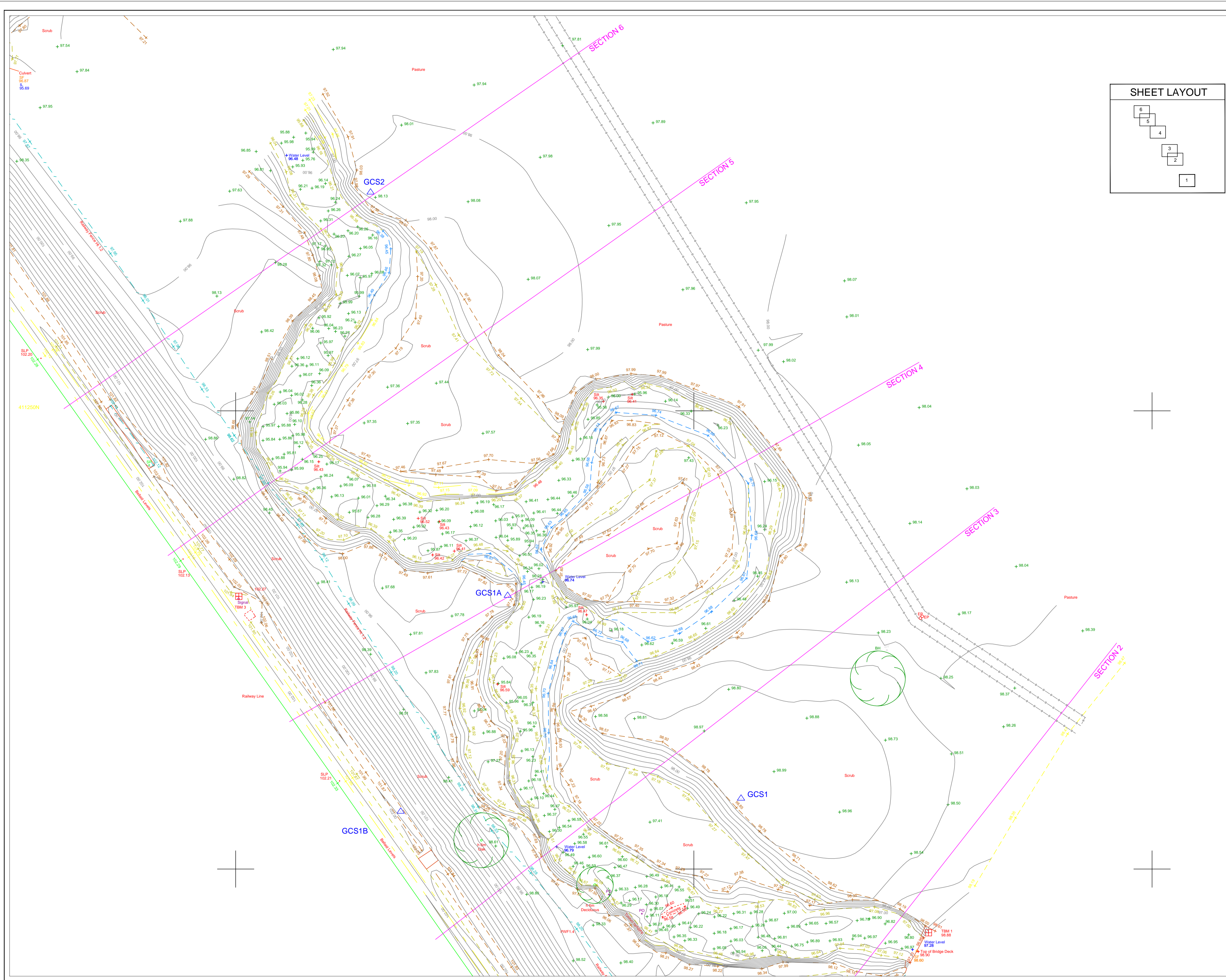

Note
Every effort is made to identify all visible above ground features, however it should be borne in mind that there may be items obscured at the time of survey

LEGEND

SURVEY STATION	△ GCS1	AIR VALVE	AV
BUSHES	(Symbol)	BOLLARD	BD
HEDGES	(Symbol)	BORE HOLE	BHL
TREES	(Symbol)	BUS STOP	BS
GATE	(Symbol)	BT INSPECTION COVER	BT
BUILDING	(Symbol)	CABLE TV INSPECTION COVER	CTV
FENCES	(Symbol)	CATCH PIT	CP
OVERHEAD CABLES	(Symbol)	COVER LEVEL	CL
		DOWN PIPE	DP
		DROPPED KERB	DK
		ELECTRICITY CONTROL BOX	ECB
		EARTH ROD	ER
		ELECTRICITY POLE	EP
		EAVES HEIGHT	EH
		FINISHED FLOOR LEVEL	FFL
		FIRE HYDRANT	FW
		FUUL WATER	FV
		GULLY	GY
		GATE POST	GP
		GAS VALVE	GV
		INSPECTION COVER	IC
		INVERT LEVEL	IL
		KERB OUTLET	KO
		LAMPPOST	LP
		LITTER BIN	LB
		MANHOLE	MH
		SERVICE MARKER POST	SMK
		ELECTRICITY Pylon	PYL
		RODDING EYE	RE
		RIDGE HEIGHT	RH
		ROAD NAMEPLATE	RN
		ROAD SIGN	RS
		SOFFIT LEVEL	SF
		SLEEPER LEVEL	SLP
		STAY	ST
		STORM WATER	SW
		WATER TAP	TAP
		TELEPHONE CALL BOX	TGB
		THRESHOLD LEVEL	THL
		TRAFFIC LIGHT	TL
		TELEGRAPH POLE	TP
		UNABLE TO LIFT	UTL
		VENT PIPE	VP
		WATER LEVEL	WL
		WATER METER	WM
		WASHOUT	WO

Control Table

Station	Description	Easting	Northing	Level
GCS1	Peg			
GCS2	Peg			
GCS3	Peg			
GCS4	Peg			
GCS5	Peg			
GCS6	Peg			
GCS7	Peg			
GCS8	Peg			
GCS9	Peg			
GCS10	Peg			
GCS1A	Peg			
GCS1B	Peg			
GCS1C	Peg			

Grid and Datum
Based upon - Grid Datum: National Grid, Level Datum: Ordnance Datum
All levels refer to Permanent Ordnance Survey GPS Stations and related to Ordnance Datum Newlyn via the geoid model OSGM02.
No scale factor has been applied to this survey. Surveyed 21/11/11

Title:
SAMPLE RIVER AND RAIL SURVEY
(Topographic Survey)

Client:

Grantham Coates Surveys Ltd.
Land - Engineering - Building Surveyors
Minerva Mill, Station Road, Alcester, Warwickshire, B49 5ET
Tel: 01789 761386 - Fax: 01789 400447
E-Mail: info@gcsurveys.co.uk
Web Site: www.gcsurveys.co.uk

Drawing No:	GCS/SAMPLE/1	Rev:	
Date:	Notes:	Name:	Rev:
Drawn:	Checked:	Scale:	Date:
CC	JMG	1:200	
File Name:	Sheet size:	Sheet:	
GCS-SAMPLE-1.DWG	A1	2 of 6	